

Figure 1: PROJECT LOCATION

IH 10 AT SAN JACINTO RIVER
HARRIS COUNTY | CSJ: 0508-01-369
TxDOT HOUSTON DISTRICT - FEBRUARY 2020



OVERALL PLAN VIEW

TABLE 4: SUMMARY OF POTENTIAL WATERS OF THE U.S. WITHIN THE IH 10 PROJECT AREA

Feature Number	Feature Name	Aquatic Resource Type	Average OHWM within Project Area (feet)	Existing Structure	Potentially Jurisdictional? (Yes/No)	Location		Linear Feet/ Acres of Potential Waters of the U.S. Within the Existing ROW	Linear Feet/ Acres of Perm. Impacts to Potential Waters of the U.S.	Proposed Structure/ Work	Regulated under Section 10 and/or Section 404?	Permit Potentially Required - Type?	
						Latitude	Longitude						
WOUS 1	San Jacinto River	Open Water	40 feet	Bridge; Culvert	Yes	29.792608	-95.061855	610 linear feet/ 6.996 acre	338.4 linear feet/ 0.193 acre	Fender System, Dolphin Structures, and Rip Rap	Section 10	Yes, Individual Permit	
Wetland A	Adjacent San Jacinto River	Herbaceous Wetland	N/A	Bridge	Yes	29.794783	-95.065328	1.139 acre	None	None	404	No	
Wetland B	Adjacent San Jacinto River	Fringe Wetland	N/A	Bridge	Yes	29.793518	-95.062616	0.211 acre	None	None	404	No	
Wetland C	Within 100-Yr Floodplain of San Jacinto River	Herbaceous Wetland	N/A	None	Yes	29.793531	-95.062943	0.036 acre	None	None	404	No	
WOUS Totals								610 linear feet/ 6.996 acre	338.4 linear feet/ 0.193 acre				
Wetland Totals								1.386 acre	0.000 acre				
Project Totals								610 linear feet/ 8.382 acres	338.4 linear feet/ 0.193 acre				

PAGE 1 OF 8

LEGEND

-  Project Boundary
-  Total Permanently Impacted Waters of the U.S. (0.193 acres, 2,563 CY, 338.4 LF)
-  Total Avoided Waters of the U.S. (8.188 acres)

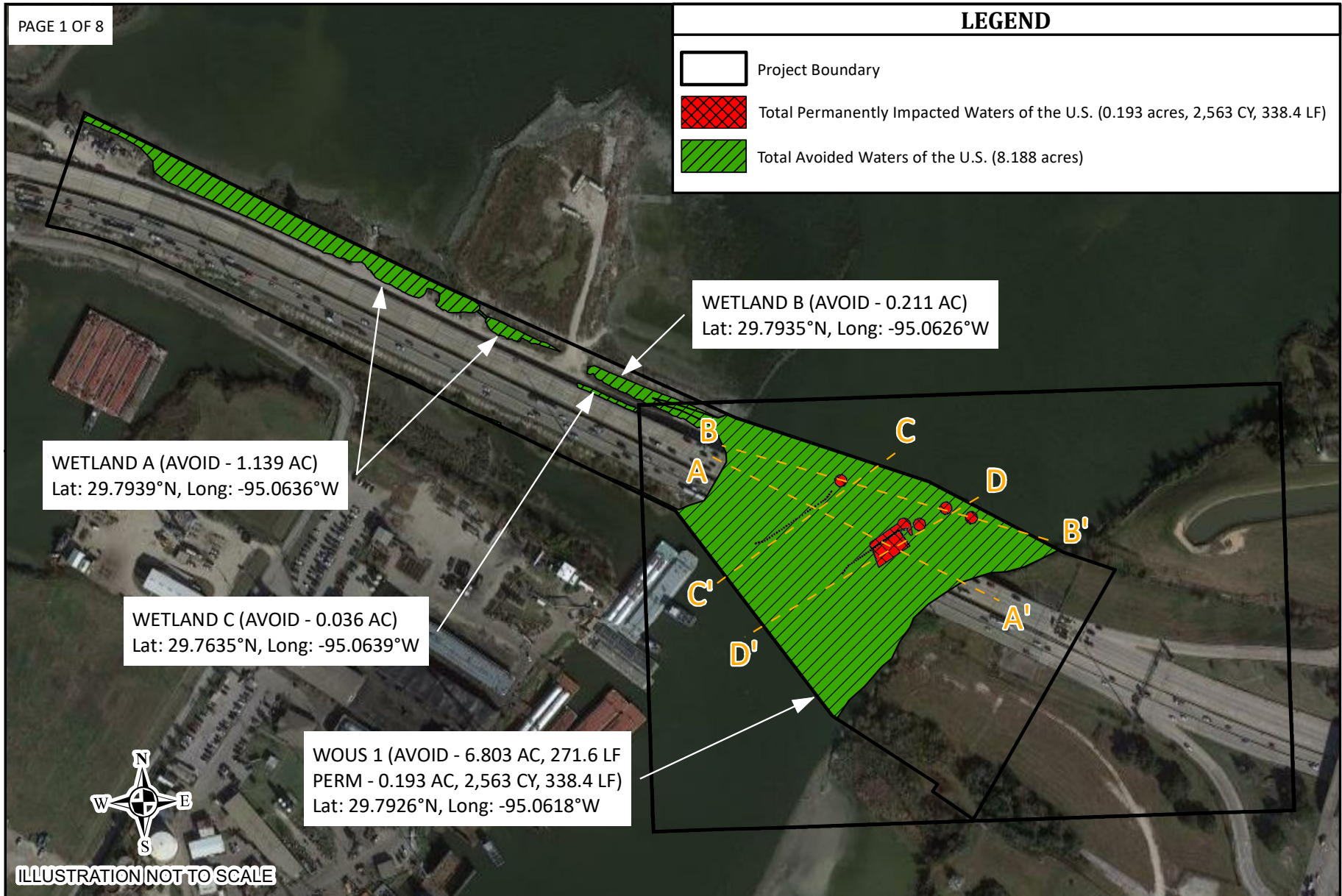

WETLAND A (AVOID - 1.139 AC)
Lat: 29.7939°N, Long: -95.0636°W

WETLAND B (AVOID - 0.211 AC)
Lat: 29.7935°N, Long: -95.0626°W

WETLAND C (AVOID - 0.036 AC)
Lat: 29.7635°N, Long: -95.0639°W

WOUS 1 (AVOID - 6.803 AC, 271.6 LF
PERM - 0.193 AC, 2,563 CY, 338.4 LF)
Lat: 29.7926°N, Long: -95.0618°W

ILLUSTRATION NOT TO SCALE



Figure 2a: PROPOSED IMPACTS

IH 10 AT SAN JACINTO RIVER
HARRIS COUNTY | CSJ: 0508-01-369
TxDOT HOUSTON DISTRICT - FEBRUARY 2020

OVERALL PLAN VIEW

PAGE 2 OF 8

LEGEND

-  Project Boundary
-  Total Permanently Impacted Waters of the U.S. (0.193 acres, 2,563 CY, 338.4 LF)
-  Total avoided for Waters of the U.S. (8.188 acres)

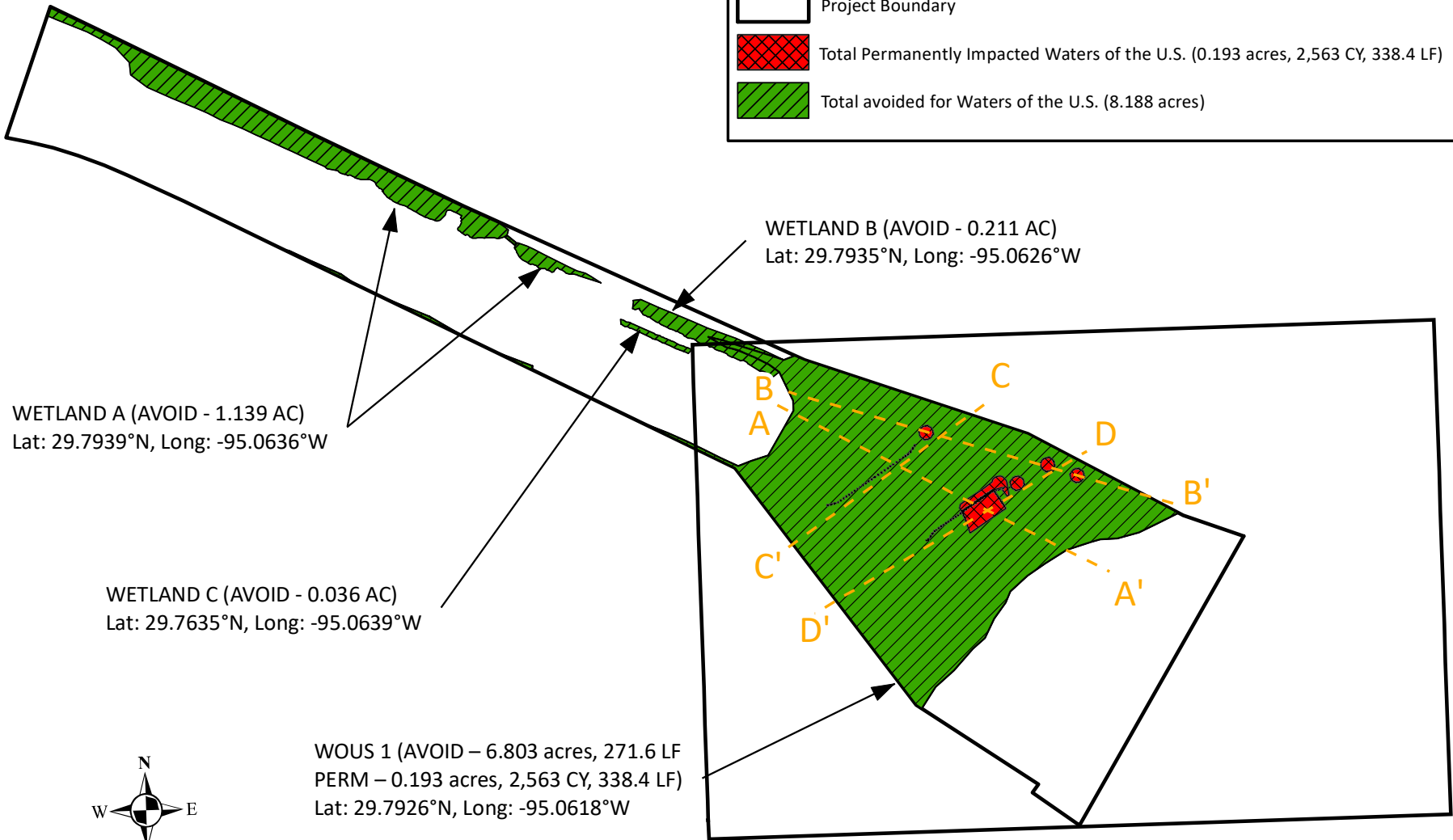

ILLUSTRATION NOT TO SCALE

Figure 2b: PROPOSED IMPACTS

IH 10 AT SAN JACINTO RIVER
HARRIS COUNTY | CSJ: 0508-01-369
TxDOT HOUSTON DISTRICT - FEBRUARY 2020

OVERALL PLAN VIEW

PAGE 3 OF 8

LEGEND

- Project Boundary
- Total Permanently Impacted Waters of the U.S. (0.193 acres, 2,563 CY, 338.4 LF)
- Total avoided for Waters of the U.S. (8.188 acres)

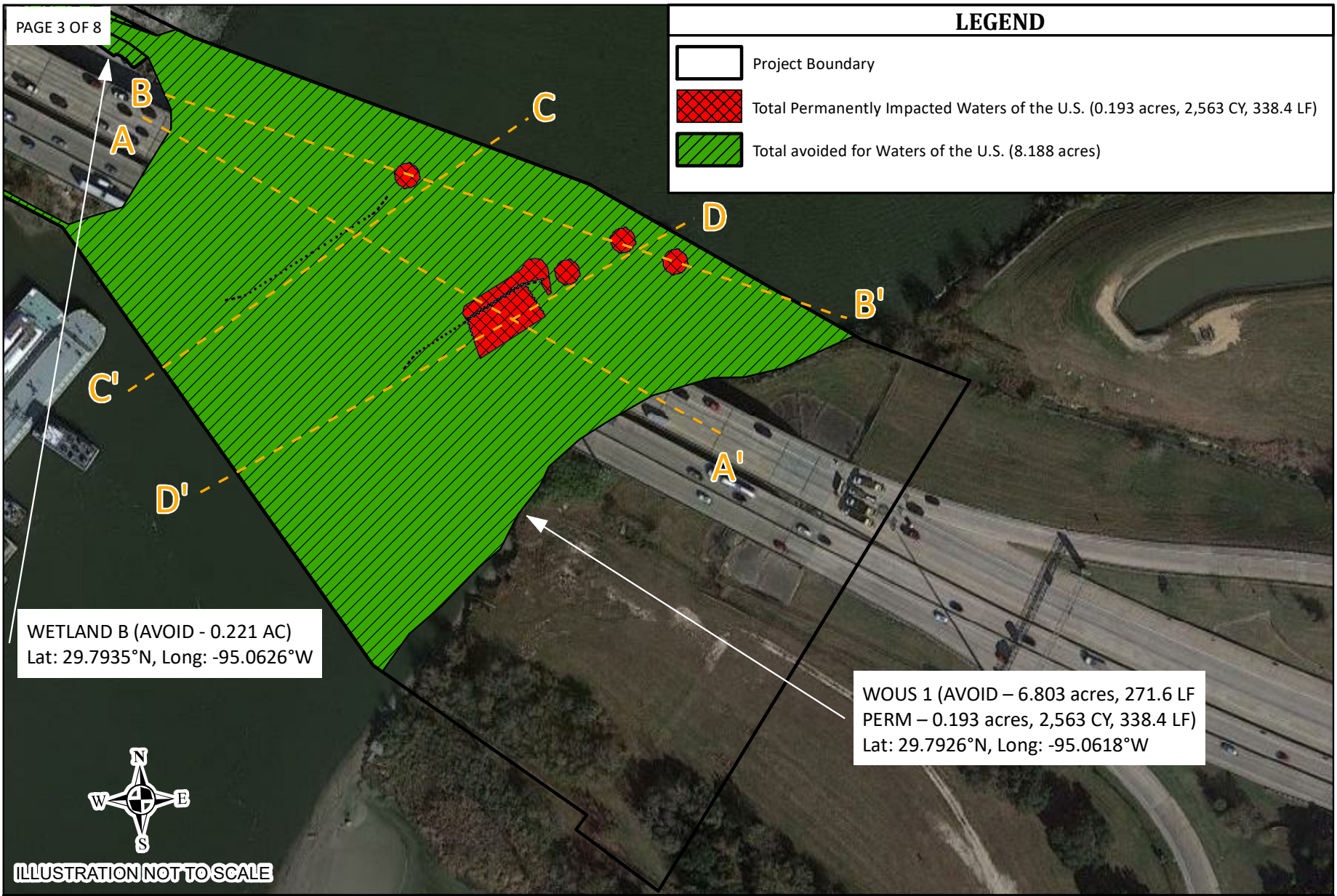

WETLAND B (AVOID - 0.221 AC)
 Lat: 29.7935°N, Long: -95.0626°W

WOUS 1 (AVOID - 6.803 acres, 271.6 LF
 PERM - 0.193 acres, 2,563 CY, 338.4 LF)
 Lat: 29.7926°N, Long: -95.0618°W





ILLUSTRATION NOT TO SCALE

Figure 2c: PROPOSED IMPACTS
 IH 10 AT SAN JACINTO RIVER
 HARRIS COUNTY | CSJ: 0508-01-369
 TxDOT HOUSTON DISTRICT - FEBRUARY 2020

OVERALL PLAN VIEW

PAGE 4 OF 8

LEGEND

-  Project Boundary
-  Total Permanently Impacted Waters of the U.S. (0.193 acres, 2,563 CY, 338.4 LF)
-  Total avoided for Waters of the U.S. (8.188 acres)

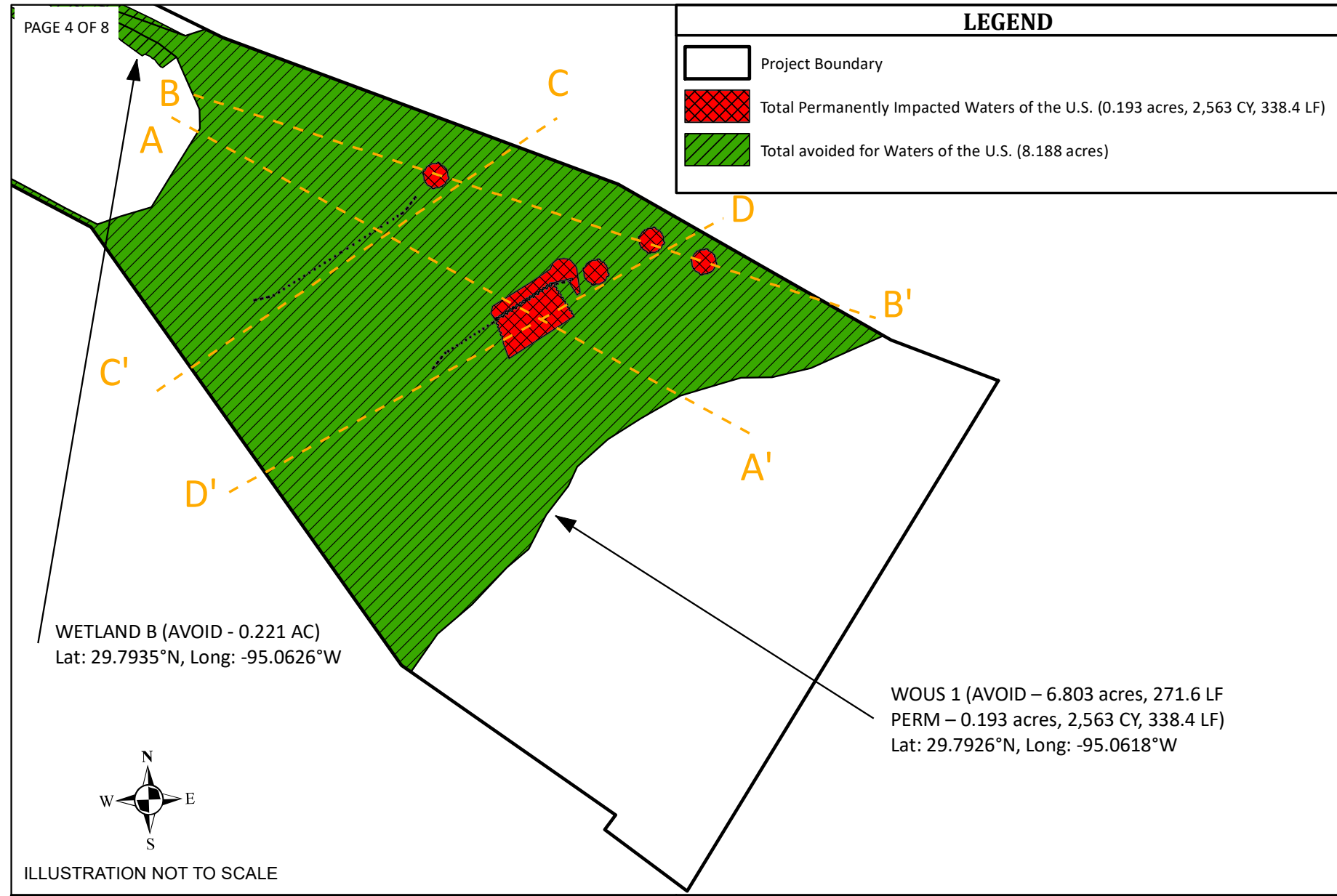

Figure 2d: PROPOSED IMPACTS



IH 10 AT SAN JACINTO RIVER
 HARRIS COUNTY | CSJ: 0508-01-369
 TxDOT HOUSTON DISTRICT - FEBRUARY 2020

OVERALL PLAN VIEW

PAGE 5 OF 8

LEGEND

AREA	ACREAGE	PERMANENT IMPACT	TEMPORARY IMPACT
WOUS 1	6.996 AC, 610 LF	0.193 acres, 2,563 CY, 338.4 LF) Fender System, Dolphin Structures, Rip Rap	N/A

-  Total Permanently Impacted Waters of the U.S. (0.193 acres, 2,563 CY, 338.4 LF)
-  Total Avoided Waters of the U.S. (8.188 acres)
-  Existing Grade

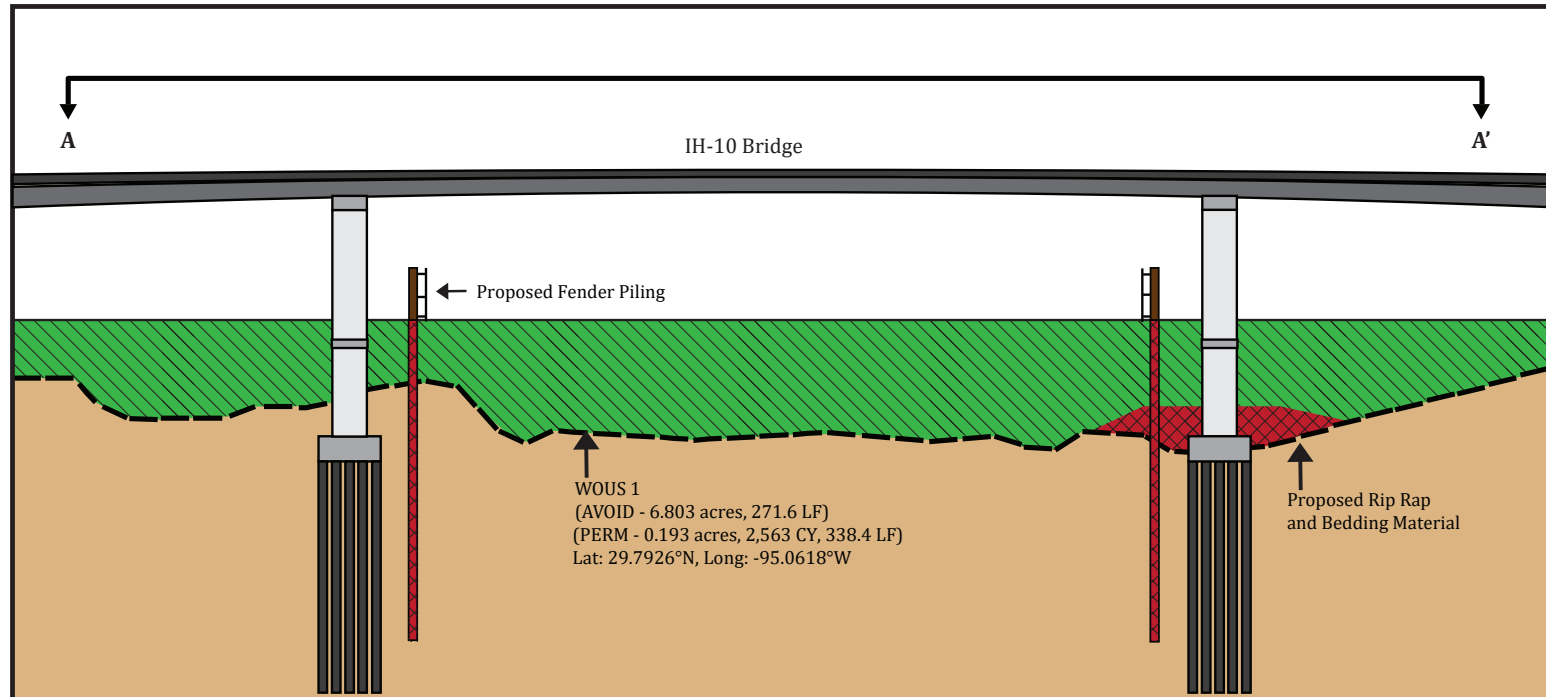

Note: No impacts to the existing bridge and bridge pilings are anticipated.



ILLUSTRATION NOT TO SCALE



Figure 2e: PROPOSED IMPACTS

IH 10 AT SAN JACINTO RIVER
HARRIS COUNTY | CSJ: 0508-01-369
TxDOT HOUSTON DISTRICT - FEBRUARY 2020

CROSS SECTION VIEW A - A'

PAGE 6 OF 8

LEGEND

-  Total Permanently Impacted Waters of the U.S. (0.193 acres, 2,563 CY, 338.4 LF)
-  Total Avoided Waters of the U.S. (8.118 acres)
-  Existing Grade

AREA	ACREAGE	PERMANENT IMPACT	TEMPORARY IMPACT
WOUS 1	6.996 AC, 610 LF	0.193 acres, 2,563 CY, 338.4 LF Fender System, Dolphin Structures, Rip Rap	N/A

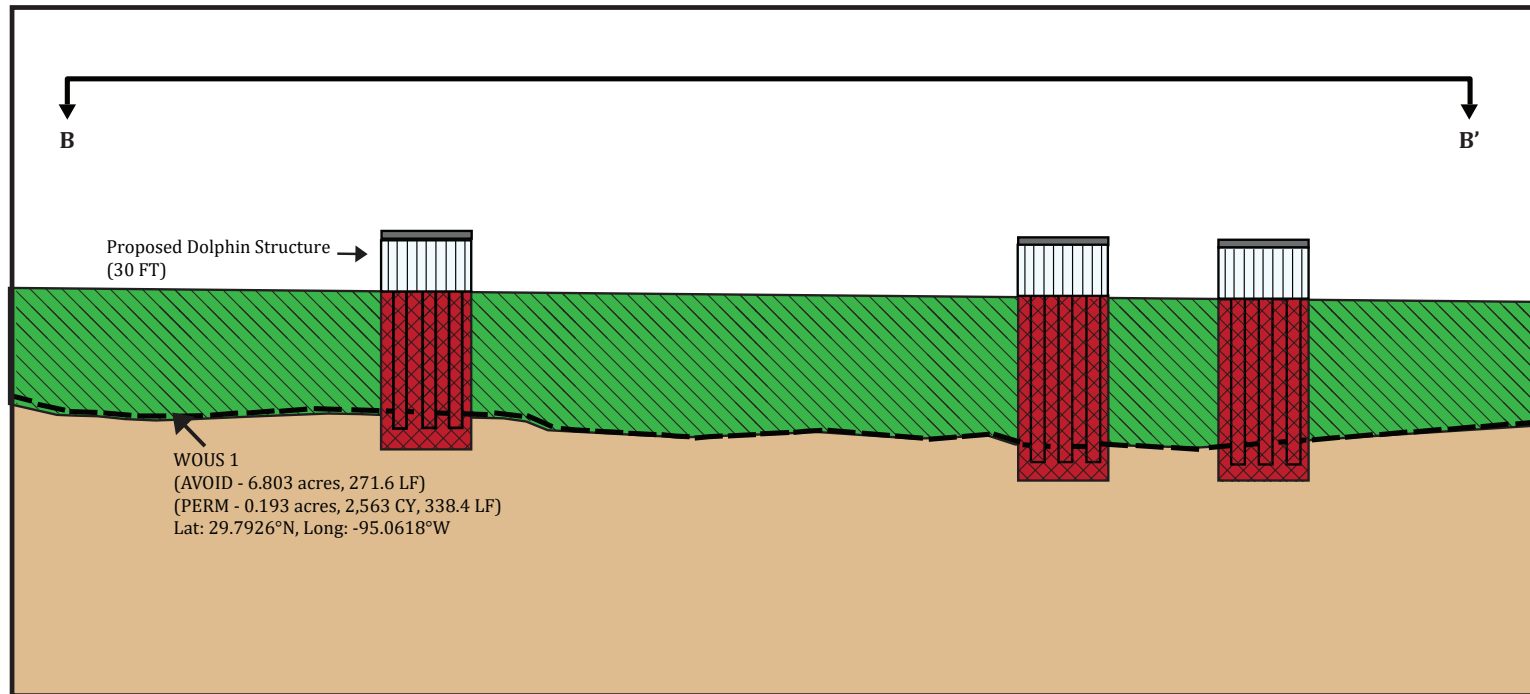

Note: No impacts to the existing bridge and bridge pilings are anticipated.

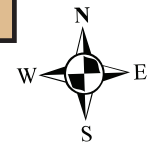

ILLUSTRATION NOT TO SCALE



Figure 2f : PROPOSED IMPACTS

IH 10 AT SAN JACINTO RIVER
HARRIS COUNTY | CSJ: 0508-01-369
TxDOT HOUSTON DISTRICT - FEBRUARY 2020

CROSS SECTION VIEW B - B'

PAGE 7 OF 8

LEGEND

-  Total Permanently Impacted Waters of the U.S. (0.193 acres, 2,563 CY, 338.4 LF)
-  Total Avoided Waters of the U.S. (8.118 acres)
-  Existing Grade

AREA	ACREAGE	PERMANENT IMPACT	TEMPORARY IMPACT
WOUS 1	6.996 AC, 610 LF	0.193 acres, 2,563 CY, 338.4 LF) Fender System, Dolphin Structures, Rip Rap	N/A

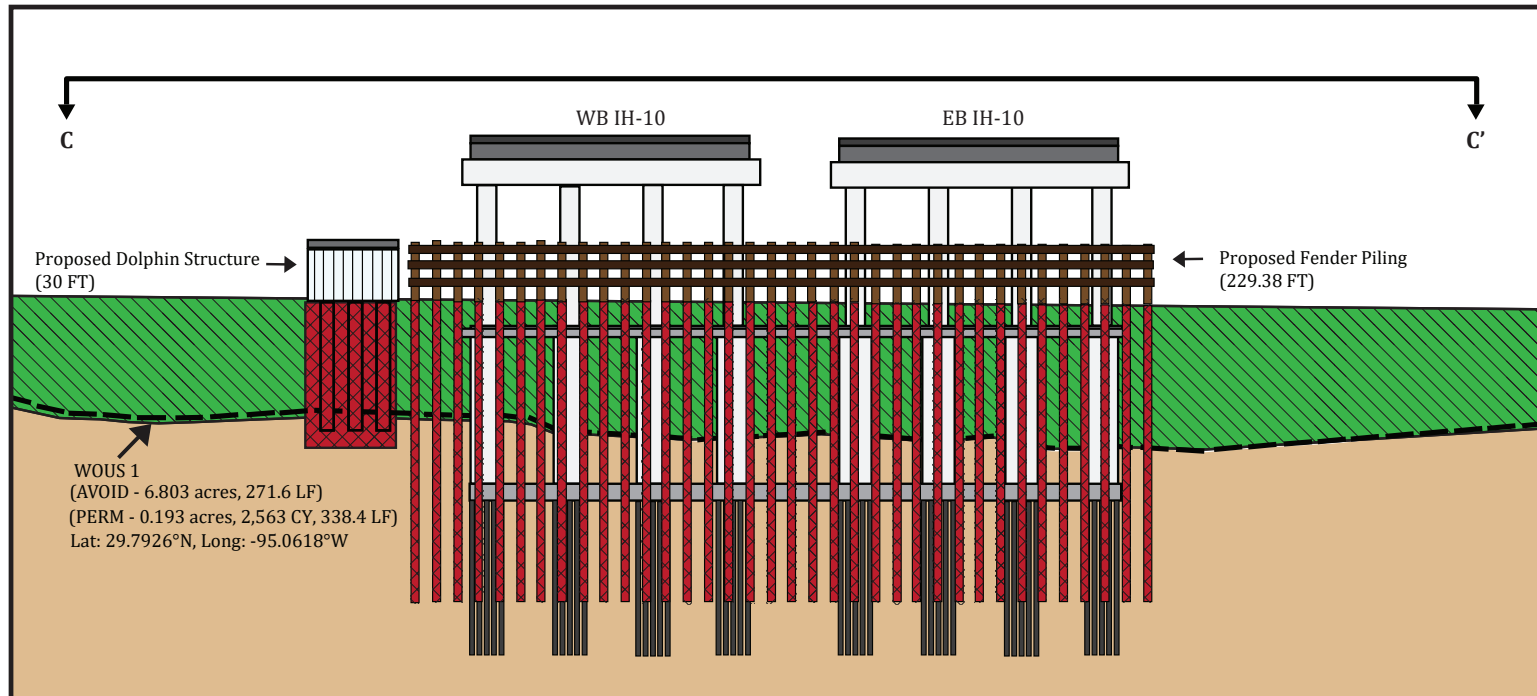

Note: No impacts to the existing bridge and bridge pilings are anticipated.

ILLUSTRATION NOT TO SCALE



Figure 2g: PROPOSED IMPACTS

IH 10 AT SAN JACINTO RIVER
HARRIS COUNTY | CSJ: 0508-01-369
TxDOT HOUSTON DISTRICT - FEBRUARY 2020

CROSS SECTION VIEW C - C'

PAGE 8 OF 8

LEGEND

-  Total Permanently Impacted Waters of the U.S. (0.193 acres, 2,563 CY, 338.4 LF)
-  Total Avoided Waters of the U.S. (8.118 acres)
-  Existing Grade

AREA	ACREAGE	PERMANENT IMPACT	TEMPORARY IMPACT
WOUS 1	6.996 AC, 610 LF	0.193 acres, 2,563 CY, 338.4 LF Fender System, Dolphin Structures, Rip Rap	N/A

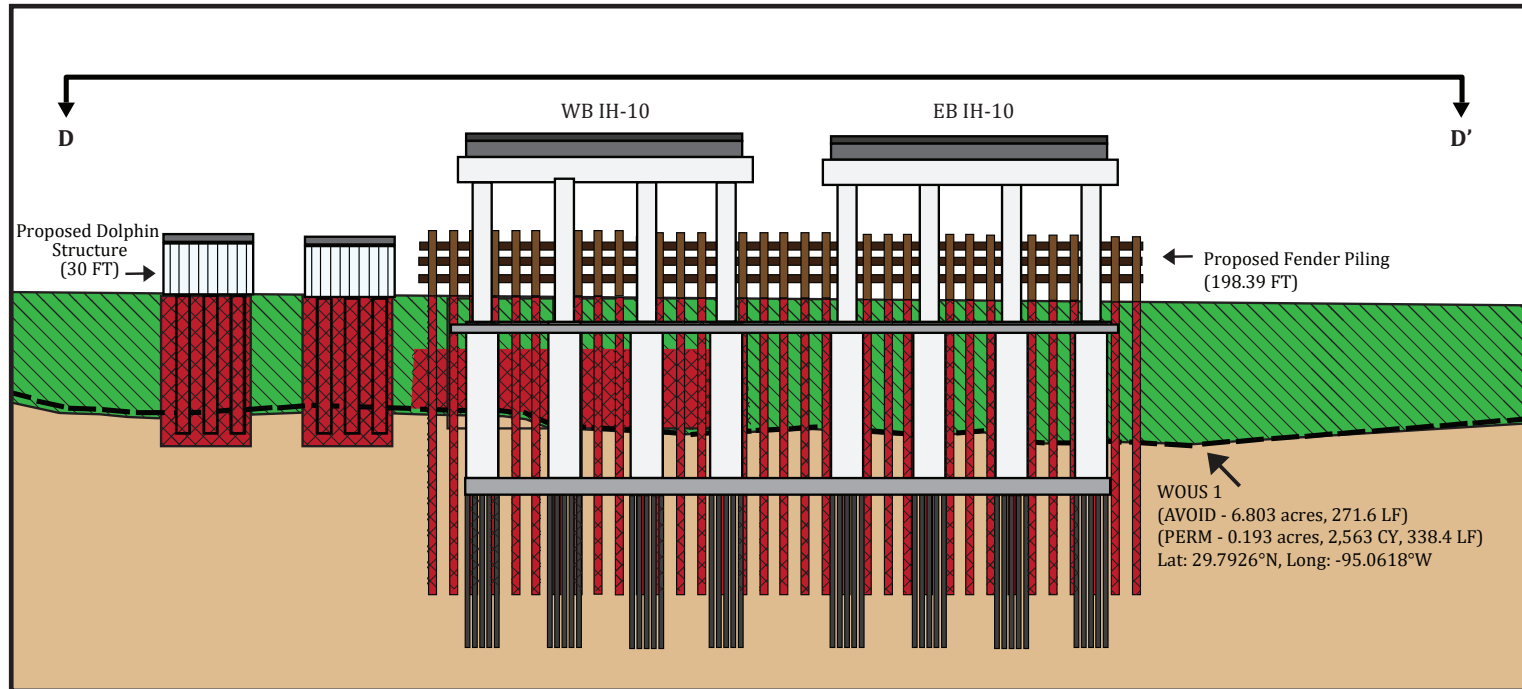

Note: No impacts to the existing bridge and bridge pilings are anticipated.

ILLUSTRATION NOT TO SCALE

Figure 2h: PROPOSED IMPACTS

IH 10 AT SAN JACINTO RIVER
HARRIS COUNTY | CSJ: 0508-01-369
TxDOT HOUSTON DISTRICT - FEBRUARY 2020

CROSS SECTION VIEW D - D'

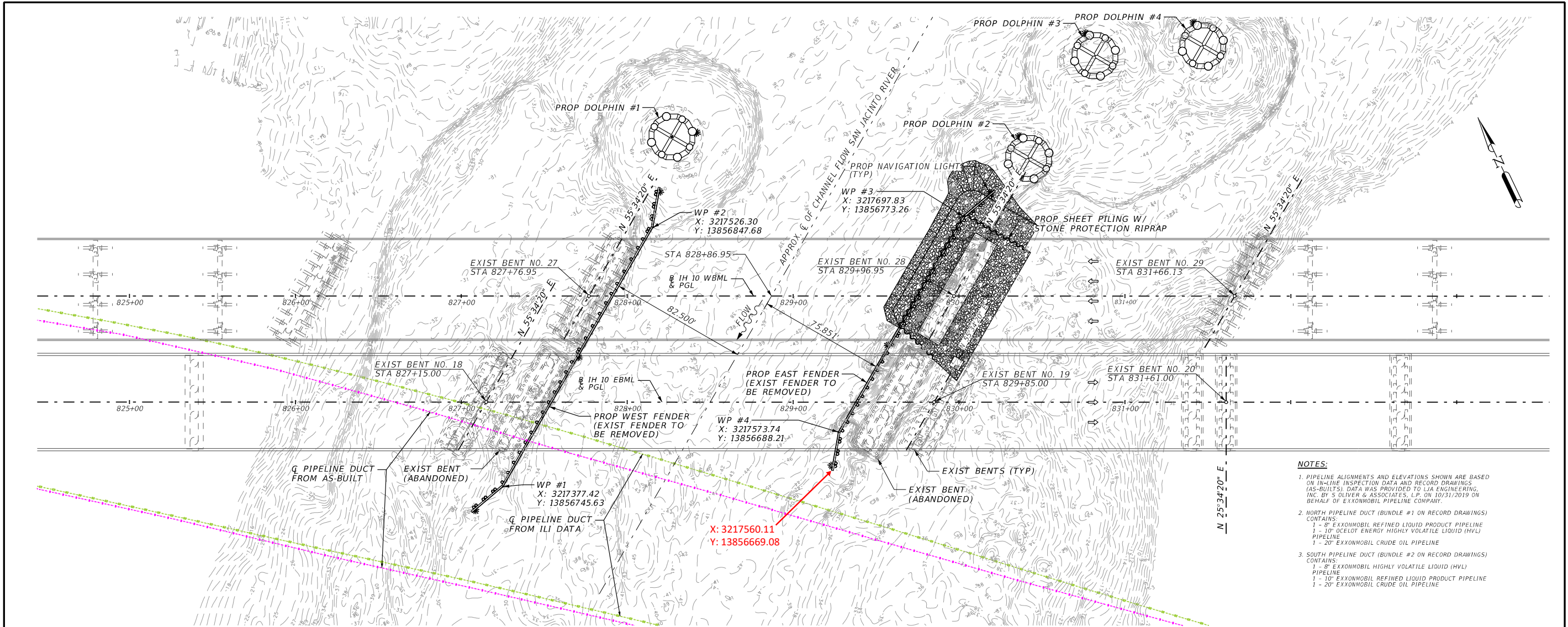

- NOTES:**
- PIPELINE ALIGNMENTS AND ELEVATIONS SHOWN ARE BASED ON IN-LINE INSPECTION DATA AND RECORD DRAWINGS (AS-BUILTS). DATA WAS PROVIDED TO LJA ENGINEERING, INC. BY S. OLIVER & ASSOCIATES, L.P. ON 10/31/2019 ON BEHALF OF EXXONMOBIL PIPELINE COMPANY.
 - NORTH PIPELINE DUCT (BUNDLE #1 ON RECORD DRAWINGS) CONTAINS:
 1 - 8" EXXONMOBIL REFINED LIQUID PRODUCT PIPELINE
 1 - 10" OCELOT ENERGY HIGHLY VOLATILE LIQUID (HVLL) PIPELINE
 1 - 20" EXXONMOBIL CRUDE OIL PIPELINE
 - SOUTH PIPELINE DUCT (BUNDLE #2 ON RECORD DRAWINGS) CONTAINS:
 1 - 8" EXXONMOBIL HIGHLY VOLATILE LIQUID (HVLL) PIPELINE
 1 - 10" EXXONMOBIL REFINED LIQUID PRODUCT PIPELINE
 1 - 20" EXXONMOBIL CRUDE OIL PIPELINE

PLAN

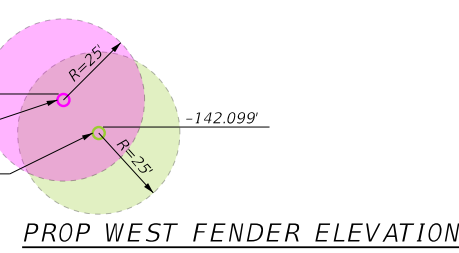
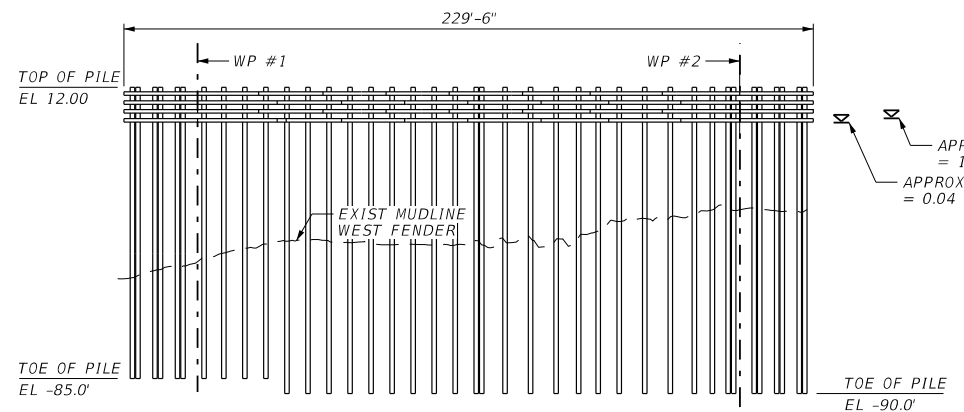

PROP WEST FENDER ELEVATION

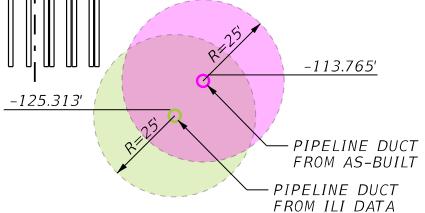
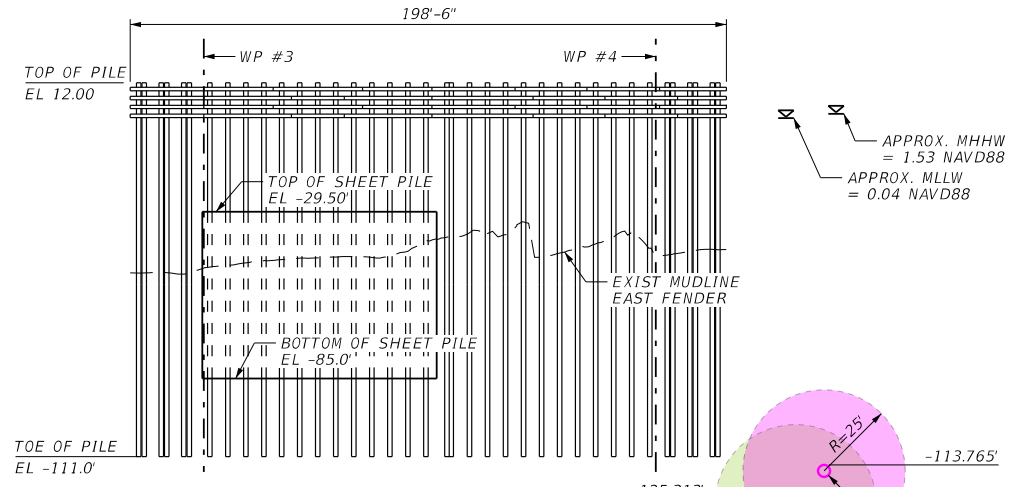

PROP EAST FENDER ELEVATION

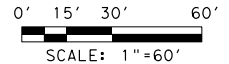

REV. NO.	DATE	DESCRIPTION	BY

LJA Engineering, Inc.
FRN - F-1386

Texas Department
of Transportation

IH 10 AT SAN JACINTO RIVER
REPLACE FENDERS AND DOLPHINS
EXXONMOBIL PIPELINES
EXHIBIT

FED. RD. DIV. NO.	STATE	PROJECT NO.	HIGHWAY NO.		
6	TEXAS	ER 1802 (631)	IH 10		
STATE DISTRICT	COUNTY	CONTROL NO.	SECTION NO.	JOB NO.	SHEET NO.
HOU	HARRIS	0508	01	369	#

1/24/2020
 J:\8007\1633\CADD\EXHIBIT\8007-1633-EXXONMOBIL PIPELINE EXHIBIT\11-15*2019.dwg
 6:43:10 AM